

High quality, efficient and dependable

The imageRUNNER ADVANCE 6500i Series delivers high performance and quality black-and-white output for demanding office environments. These intelligent systems enhance productivity through improved document workflows and an intuitive user experience.

Workflow Efficiency

- An intuitive user interface with a large, responsive colour touchscreen with smartphone-like usability makes carrying out tasks easy.
- Advance Personalisation enables a unique, personal experience across a fleet, creating a customised user experience tailored to meet each user's workflow needs.
- Canon's MEAP platform provides support for a range of integrated solutions designed to simplify workflow and help provide a holistic business solution.
- Scalable support for mobile and flexible work styles can increase efficiency by allowing workers to capture or print documents using Canon Business Print app.
- Support for scanning and converting documents to a Searchable PDF, Microsoft® Word, and Microsoft® PowerPoint files is available as an option.
- Intelligent features, such as motion sensor technology to wake the device from sleep mode and the ability to remove blank pages when scanning, help maximise productivity.

Cost Management

- The ability to apply print policies, monitor output, and restrict usage by user helps reduce unnecessary printing, encourages cost recovery, and can help save money on paper and toner.
- Tight integration with output management solutions, such as uniFLOW, provides the ability to carry out detailed tracking, reporting, and cost analysis.
- Quality and reliability, combined with remote diagnostics and assistance, can help reduce costs by minimising downtime and time spent by IT resolving issues.
- Consistent user operation combined with remote and centralised fleet management can help simplify IT management of devices and entire fleets.

Security

- Control who has access to the device with authentication by using the standard Picture Login authentication.
- Help prevent unauthorised distribution of sensitive information with an array of standard and optional document security features.
- Help ensure information privacy and security across your entire network with IPsec, port filtering capabilities, and SSL technology.



Device and Fleet Management Efficiency

- Ease administrative burdens and increase uptime with eMaintenance. Automate your fleet maintenance task, improve consumables management and gain better control of networked devices.
- Standard PCL support integration with enterprise applications and legacy systems to help streamline business processes.

Reliability

- Canon's signature reliability and engine technologies provide high quality output to meet the needs of busy departments.
- State-of-the-art imaging technologies and toner allow for consistently striking images in rich black-and-white tones and 1,200 dpi print resolution.
- Designed to achieve maximum uptime with status notifications to help keep supplies replenished, intuitive user walkthrough videos guide users to replace toner on the fly.

Sustainability

- Fusing technologies, Precise Output (pO) toner, and innovative sleep mode features help lower overall energy consumption.
- Help minimise waste with 2-sided printing, secure printing, and the ability to hold print jobs, preview them and change print settings at the device, helping to achieve the results you want the first time.
- Incorporates sustainable design, with the use of recycled materials and bio-based plastic in some parts, and a focus on minimising environmental impact.

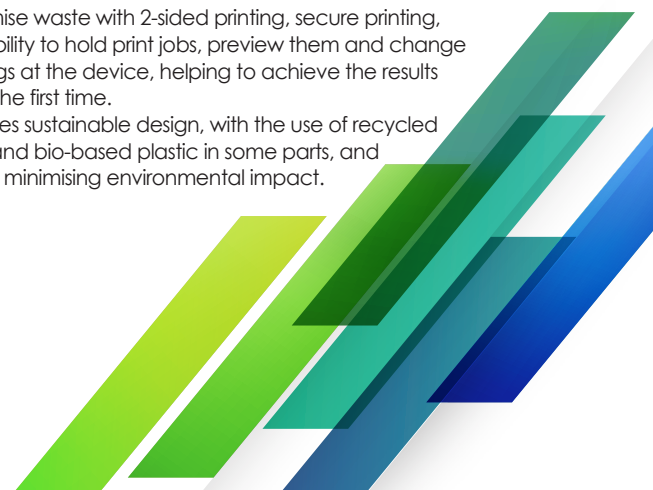

Configuration

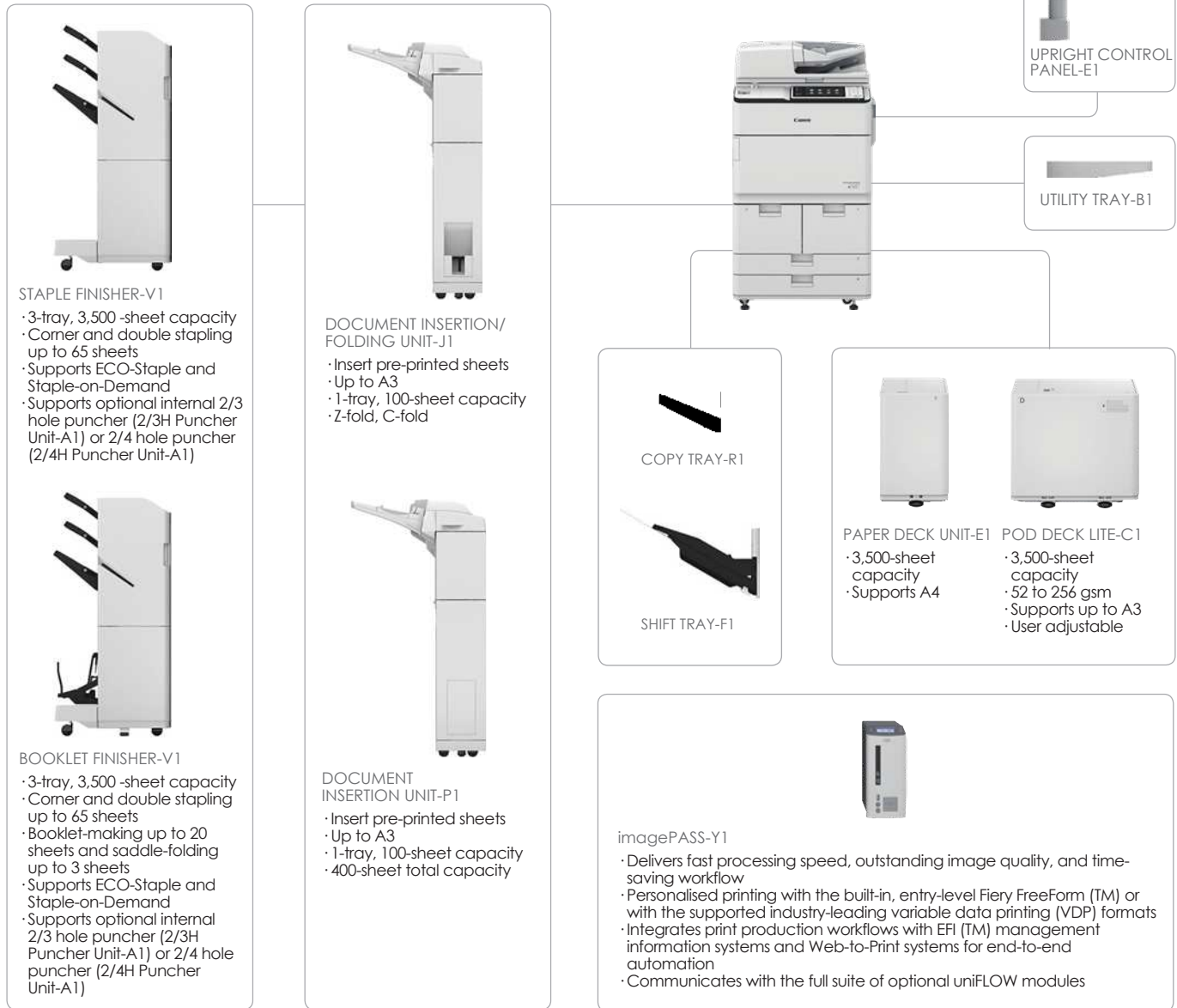

MAIN UNIT

Machine Type

Monochrome Laser Multifunctional

Core Functions

Print, Copy, Scan, Send, Store and Optional Fax

Control Panel

10.1 inch TFT LCD WSVGA Colour Touchpanel, Optional 10.4 inch TFT LCD SVGA Colour Touchpanel

Memory

Standard: 3.0GB RAM

Hard Disk Drive

Standard: 250GB

Maximum: 1TB

Mirroring Hard Disk Drive

Optional 250GB or 1TB

Interface Connection

Network

Standard: 1000Base-T/100Base-TX/10Base-T, Wireless LAN (IEEE 802.11 b/g/n)

Others

Standard: USB 2.0 x2 (Host), USB 3.0 x1 (Host), USB 2.0 x1 (Device)

Optional: Serial Interface, Copy Control Interface

Paper Input (Standard)

1,500 sheets x 2 paper drawers + 550 sheets cassettes x 2 cassettes (80gsm) 100 sheets Multi-purpose tray(80gsm)

Paper Input (Option)

POD DECK LITE-C1: 3,500 sheets (80gsm)

PAPER DECK UNIT-E1: 3,500 sheets (80gsm)

Maximum Paper Input Capacity

7,700 sheets (80gsm)

Paper Output Capacity

With Copy Tray : 250 sheets (80gsm)

With External Finishers: Max. 3,500 sheets (A4)

Finishing Capabilities

With Shift Tray: 500 sheets (80gsm)

With External Finishers: Max. 3,500 sheets (A4)

Supported Media Types

Upper Left/Right Cassettes(1/2):

Thin paper, Plain paper, Recycled paper, Colour paper, Heavy paper, Pre-punched paper, Letterhead, Bond paper

Lower Cassettes (3/4):

Thin paper, Plain paper, Recycled paper, Colour paper, Heavy paper, Pre-punched paper, Letterhead, Bond paper, Tab paper*

* Tab paper can be fed from both cassette 3 & 4 when the optional TAB FEEDING ATTACHMENT KIT-B1 is installed.

Multi-purpose Tray:

Thin paper, Plain paper, Recycled paper, Colour paper, Heavy paper, Pre-punched paper, Bond, Transparency, Labels, Letterhead, Clear Film, Tab paper, Tracing*

POD DECK LITE-C1:

Thin paper, Plain paper, Recycled paper, Colour paper, Heavy paper, Pre-punched paper, Letterhead, Bond paper

PAPER DECK UNIT-E1:

Thin paper, Plain paper, Recycled paper, Colour paper, Heavy paper, Pre-punched paper, Letterhead, Bond paper

Supported media sizes

Upper Left/Right Drawers (1/2):

Standard size: A4

Lower Cassettes (3/4):

Standard size: A3, A4, A4R, A5R

Custom size: 139.7 mm x 182 mm to 297 mm x 431.8 mm

Multi-purpose Tray:

Standard size: A3, A4, A4R, A5R

Custom Size : 100 mm x 148 mm to 297 mm x 431.8 mm

Free size: 100mm x 182mm to 330.2mm x 487.7mm

POD DECK LITE-C1: C1: A3, A4, A4R, B5, A5R and Custom

Size(139.7mm x 182mm to 297mm x 431.8mm)

PAPER DECK UNIT-E1: A4, B5

Supported Media Weights

Cassettes: 52 to 220 gsm

Multi-purpose tray: 52 to 256 gsm

Duplex: 52 to 220 gsm

Warm-up Time

From Power On: 30 Seconds or Less

From Sleep Mode: 30 Seconds or Less

Quick Startup Mode: 3 Seconds*2

Dimensions (W x D x H)

670 mm x 779 mm x 1,220 mm

Installation Space (W x D)

1,533 mm x 779 mm

(Basic: Only Multi-purpose tray + Cassette drawers open + Copy Tray)

2,065 mm x 1,353 mm

(Fully configured: Includes Booklet finisher + A3 Paper Deck +

Insertion and folding unit + Puncher unit + Cassette drawers open)

Weight Approx. 234kg*3

Print Specifications

Printing Method

Monochrome laser beam printing

Print Speed

iR-ADV 6555i 32 ppm (A3)

55 ppm (A4)

iR-ADV 6565i 32 ppm (A3)

65 ppm (A4)

iR-ADV 6575i 37 ppm (A3)

75 ppm (A4)

Print Resolution

1,200 dpi x 1,200 dpi, 600 dpi x 600 dpi

Page description languages

UFR II, PCL, Adobe PS 3 (optional)

Double Sided Printing

Automatic (Standard)

Direct Print

Direct printing available from USB memory key, Advanced box, Remote UI and Web Access**

Fonts

PCL fonts: 93 Roman, 10 Bitmap fonts, 2 OCR fonts, Andalé Mono WT J/K/S/T* (Japanese, Korean, Simplified and Traditional Chinese)* Requires optional PCL INTERNATIONAL FONT SET-A1.

PS fonts: 136 Roman

Operating System

UFRIL: Server 2003/Server 2003 R2/Vista/Server 2008/Windows 7/Server 2008 R2/Windows 8/Server 2012/Windows 8.1/Server 2012 R2/Windows 10, MAC OS X (10.5.8 or later)

PCL: Server 2003/Server 2003 R2/Vista/Server 2008/Windows 7/Server 2008 R2/Windows 8/Server 2012/Windows 8.1/Server 2012 R2/Windows 10

PS: Server 2003/Server 2003 R2/Vista/Server 2008/Windows 7/Server 2008 R2/Windows 8/Server 2012/Windows 8.1/Server 2012 R2/Windows 10, MAC OS X (10.5.8 or later)

PPD: MAC OS 9.1 or later, MAC OS X (10.3.9 or later), Windows Vista/Windows 7/Windows 8/Windows 8.1/Windows 10

Copy Specifications

Copy Speed

IR-ADV 6555i 32 ppm (A3)
55 ppm (A4)

IR-ADV 6565i 32 ppm (A3)
65 ppm (A4)

IR-ADV 6575i 37 ppm (A3)
75 ppm (A4)

First-Copy-Out Time

IR-ADV 6555i: Approx. 3.3 seconds or less

IR-ADV 6565i: Approx. 3.3 seconds or less

IR-ADV 6575i: Approx. 3.1 seconds or less

Copy Resolution

Reading: 600 dpi x 600 dpi

Printing: 1,200 dpi x 1,200 dpi

Multiple Copies

Up to 9,999 copies

Copy Exposure

Automatic or Manual (9 Levels)

Magnification

25% - 400% (1% Increments)

Preset Reductions

25%, 50%, 64%, 73%, 78%

Preset Enlargements

121%, 129%, 200%, 400%

Scan Specifications

Standard

Colour flatbed scan unit and 300-sheet duplex automatic document feeder (1-Pass duplex colour scan).

Type

Colour flatbed plus Single-pass duplex automatic document feeder (1-Pass Duplex Scan)

Supported media size/s A3, A4, A4R, A5, A5R

Supported media weight/s

Single-sided scanning: 38 to 220 gsm (BW)

Single-sided scanning: 64 to 220 gsm (CL)

Double-sided scanning: 50 to 220 gsm (BW)

Double-sided scanning: 64 to 220 gsm (CL)

Pull Scan Spec

Colour Network ScanGear2. For both Twain and WIA

Supported OS: Windows Vista/7/8/8.1/10 Windows Server 2003/Server 2003 R2/Server 2008/Server 2008 R2/Server 2012/Server 2012 R2

Scan Resolution

100 x 100dpi, 150 x 150 dpi, 200 x 100 dpi, 200 x 200 dpi, 200 x 400 dpi, 300 x 300 dpi, 400 x 400 dpi, 600 x 600 dpi

Acceptable Originals

Platen: Sheet, Book, 3-Dimensional Objects [Up to 2kg]

Scan Speed (BW/Colour; A4)

Single-sided (A4, 600 dpi): 120/60 ipm (BW/CL);

Double-sided (A4, 300 dpi): 240/220 ipm (BW/CL)

Paper Capacity

300 Sheets (80 gsm)

Double sided scanning

2-sided to 2-sided (Automatic)

Send Specifications

Optional/ Standard Standard on all models

Destination E-mail/Internet FAX (SMTP), SMB, FTP, WebDAV

Colour Mode

Automatic-Colour Select (Full Colour/Grayscale), Automatic-Colour Select(Full Colour/Black-and-White), Full colour, Grayscale, and Black-and-White

Address Book

LDAP (2,000)/Local (1,600)/Speed dial (200)

Send Resolution

100 x 100dpi, 150 x 150 dpi, 200 x 100 dpi, 200 x 200 dpi, 200 x 400 dpi, 300 x 300 dpi, 400 x 400 dpi, 600 x 600 dpi

Communication Protocol

File: FTP, SMB, WebDAV

E-mail/I-Fax: SMTP, POP3, I-Fax (Simple, Full)

File Format

Standard: JPEG, TIFF, PDF/XPS (Compact), PDF (PDF/A-1b, Optimize for Web, Apply Policy)

Optional: PDF(Trace&Smooth, Encrypted), PDF/XPS (Digital Signature), PDF/XPS(Searchable), Office Open XML(PowerPoint, Word)

Fax Specifications

Optional on all models

Maximum Number of Connection Lines 4

Modem Speed Super G3: 33.6 kbps
G3: 14.4 kbps

Compression Method MH, MR, MMR, JBIG

Resolution 400 x 400 dpi, 200 x 400 dpi, 200 x 200 dpi, 200 x 100 dpi

Sending/Recording Size A3, A4, A4R, A5 *, A5R *2

*1 Pels stands for picture elements (pixels)

*2 Sent as A4

FAX Memory Up to 6,000 pages

Speed Dials Max. 200

Group dials/destinations Max. 199 dials

Sequential broadcast Max. 256 addresses

Memory backup Yes

Store Specifications

Mail Box (Number supported)

100 User Inboxes, 30,000 Maximum Pages Stored

Advanced Box

Communication Protocol: SMB or WebDAV

Supported Client PC: Windows (Windows Vista/7/8/8.1/10)

Concurrent Connections (Max.):

SMB: 64

WebDAV: 3 (Active Sessions)

Advanced Box Available Disc Space

Approx. 16GB (Standard HDD)

Approx. 480GB (1TB HDD)

Memory Media Standard: USB Memory

Security Specifications

Authentication

Standard: Picture Login Authentication, Department ID Authentication (Device and Function Level Log-in), Access Management System

Optional: My Print Anywhere secure print (Requires uniFLOW)

Data

Standard: Trusted Platform Module (TPM), Hard Disk Drive Erase, Hard Disk Drive Encryption (FIPS 140-2 Level 2), Hard Disk Password Lock, Mail Box Password Protection

Optional: Hard Disk Drive Mirroring, Removable HDD Kit, IEEE Common Criteria Certification

Network

Standard: IP/Mac Address Filtering, IPSEC, TLS Encrypted Communication, SNMP V3.0, IEEE 802.1X, IPv4/IPv6, SMTP Authentication, POP Authentication before SMTP

Document

Standard: Secure Print

Optional: Encrypted PDF, Encrypted Secure Print, User and Device Signature PDF/XPS, Secure Watermarks, Document Scan lock

Environment Specifications

Operating Environment

Temperature: 10 to 30 °C (50 to 86 °F)

Humidity: 20 to 80 % RH (no condensation)

Power source 220-240V (±10 %), 50/60Hz (±2 Hz), 10Amp

Power consumption

Maximum: Approx. 2.4 kW

Standby: Approx. 260 Wh

Energy Saver Mode: Approx. 260 Wh

Sleep mode: Approx. 0.9 W or less**

Typical Electricity: 4.9 kWh (IR-ADV 6555i)

Consumption [TEC] rating²: 6.1 kWh (IR-ADV 6565i)

6.7 kWh (IR-ADV 6575i)

Noise levels

Sound Pressure¹

Active: 75 dB or Less

Standby: 58 dB or Less

Software & Print Management

Remote Management Tools

eMaintenance: Compatible with eMaintenance services via embedded RDS(Enables meter capture, automatic consumables management, remote diagnostics and reporting for service providers to offer efficient, fast and proactive maintenance)

Content Delivery System: Allows the Remote distribution of firmware, iR options and MEAP applications; Remote User Interface (RUI) Webbased interface to each device that helps to provide remote device management and control.

iW Management Console: Server-based software for centralised management of a fleet of devices (includes monitoring or consumables, status monitoring and alerts, distribution of address books, configuration settings, firmware and MEAP applications, meter capture and reporting, driver and resource management)

Scanning Software

Network ScanGear: TWAIN-compliant scanner driver that enables computers on a network to use the pull scan functionality of the device.

Platform

MEAP (Multifunctional Embedded Application Platform): A powerful JAVA Embedded Platform for Canon devices which provides tight coupling between a range of software solutions and the device.

Document Publishing

iW DESKTOP: Powerful print publishing software which easily combines documents from different sources and file formats, applies finishing with preview and templates to create professional looking documents. Includes PDF creation, annotation and compression capabilities for simple digital workflows such as proofing and authorization.

Consumables

Toner Cartridge/s NPG-54 TONER BK

Toner (Estimated Yield @6% Coverage) 56,000 pages

Paper Supply Options

PAPER DECK UNIT

Name: **POD DECK LITE-C1**

Paper Size: A3, A4, A4R, B5, A5R and Custom Size (139.7mm x 182mm to 297mm x 431.8mm)

Paper Weight: 52 to 256 gsm

Paper Capacity: 3,500 sheets (80 gsm)

Dimensions: 656 mm x 686 mm x 570 mm (W x D x H)

Weight: Approx. 68 kg

Name: **PAPER DECK UNIT-E1**

Paper Size: A4, B5

Paper Weight: 52 to 256 gsm

Paper Capacity: 3,500 sheets (80 gsm)

Dimensions: 363 mm x 630 mm x 572 mm (W x D x H)

Weight: Approx. 34 kg

Output Options

STAPLER FINISHER

Name: STAPLE FINISHER-V1 (External)

Number of Trays: 3

Tray A (Upper) Capacity: A4/A5R 250 sheets, A3/A4R 125 sheets

Tray B (Middle)Capacity: A4/A5R 250 sheets, A3/A4R 125 sheets

Tray C (Lower)Capacity: A4/A5R 3,000 sheets, A3 1,500 sheets

Paper Weight: 52 to 256 gsm

Staple Position: Corner, Double

Staple Capacity: Corner staple and Double Staple: A4: 65 sheets (90 gsm)
A3/A4R: 30 sheets (90 g/m2)
ECO-staple: A3/A4: 5 sheets (52 to 64 gsm)
4 sheets (65 to 81.4 gsm)
3 sheets (81.5 to 105 gsm)

Staple-on-Demand: 65 sheets (90 gsm)

Dimensions: 525 mm x 623 mm x 1,099 mm (W x D x H) (when the extension tray is not extended)

Weight: Approx. 35 kg

BOOKLET FINISHER

Name: BOOKLET FINISHER-V1 (External)

Number of Trays: 3

Tray A (Upper) Capacity: A4/A5R 250 sheets, A3/A4R 125 sheets

Tray B (Middle)Capacity: A4/A5R 250 sheets, A3/A4R 125 sheets

Tray C (Lower)Capacity: A4/A5R 3,000 sheets, A3 1,500 sheets

Paper Weight: 52 to 256 gsm

Staple Position: Corner, Double

Staple Capacity: Corner staple and Double Staple: A4: 65 sheets (90 gsm)
A3/A4R: 30 sheets (90 g/m²)
ECO-staple: A3/A4: 5 sheets (52 to 64 gsm)
4 sheets (65 to 81.4 gsm)
3 sheets (81.5 to 105 gsm)

Staple-on-Demand: 65 sheets (90 gsm)

Booklet Stitch paper size: A3, A4R, Custom Size (139.7 mm x 182 mm to 297 mm x 431.8 mm)

Booklet Stitch Staple Capacity: 20 sheets x 10 sets (81 gsm)
(including 1 cover sheet up to 256 gsm)
Dimensions: 525 mm x 623 mm x 1,099 mm (W x D x H)
(when the extension tray is not extended)
Weight: Approx. 58 kg

PUNCHER UNIT/S

2/3H PUNCHER UNIT-A1 Two or Three Holes
* Requires either the STAPLE FINISHER-V1 OR BOOKLET FINISHER-V1

Acceptable Punch Paper Weight: 52 to 256 gsm

Acceptable Punch Paper Size Two holes A3, B4, A4, A4R
Three holes A3, B4, A4

2/4H PUNCHER UNIT-A1 Two or Four Holes
* Requires either the STAPLE FINISHER-V1 OR BOOKLET FINISHER-V1

Acceptable Punch Paper Weight: 52 to 256 gsm

Acceptable Punch Paper Size Two holes A3, B4, A4, A4R
Four holes A3, A4

COPY TRAY

COPY TRAY-R1: Provides a simple tray for basic output needs.
Capacity: 250 sheets (80gsm)

SHIFT TRAY

SHIFT TRAY-F1: Provides offset collate function to the
output tray.
Capacity: 500 sheets (80 gsm)

DOCUMENT INSERTION UNIT

DOCUMENT INSERTION UNIT-P1 (Optional and requires
either the STAPLE FINISHER-V1 or BOOKLET FINISHER-V1)
Number of insertion trays: 1 Tray
Insertion Paper Size/ Weight: A3, A4, A4R / 60 to 256 gsm
Insertion Capacity: 100 sheets 80 gsm
Dimensions (W x D x H): 662mm x 679mm x 1,242mm
Weight: Approx. 40kg

DOCUMENT INSERTION/FOLDING UNIT

DOCUMENT INSERTION/FOLDING UNIT-J1
(Optional and requires either the STAPLE FINISHER-V1 or
BOOKLET FINISHER-V1)
Number of insertion trays: 1 Tray
Insertion Paper Size/ Weight: A3, A4, A4R / 60 to 256 gsm
Insertion Capacity: 100 sheets (80 gsm)
C-Fold Paper Size/ Weight: A4R / 60 to 105 gsm
40 sheets (80 gsm)
C-Fold Output Capacity: 40 sheets (80 gsm)
Z-Fold Paper Size/ Weight: A3, A4R/ 60 to 105 gsm
40 sheets (80 gsm)
Z-Fold Output Capacity: 40 sheets (80 gsm)
Dimensions (W x D x H): 662mm x 679mm x 1,242mm
Weight: Approx. 76kg

Hardware Accessories

CARD READERS

COPY CARD READER-F1
COPY CARD READER ATTACHMENT-A3

Others

PRINTER COVER-H1
TAB FEEDING ATTACHMENT KIT-B1
STAMP INK CRG-C1
UPRIGHT CONTROL PANEL-E1
UTILITY TRAY-B1

Security Options

Document Security

DOCUMENT SCAN LOCK KIT-B1
SECURE WATERMARK-B1-A
ENCRYPTED SECURE PRINT SOFTWARE-D1

Data Security

HDD Mirroring Kit-J1
2.5INCH/250GB HDD-N1
2.5INCH/1TB HDD-P1
REMOVABLE HDD KIT-AL1

System & Controller Options

Print Accessories

PCL INTERNATIONAL FONT SET-A1

Barcode printing

BARCODE PRINTING KIT-D1

EFI-Fiery based controller

IMAGEPASS-Y1
REMOVABLE HARD DISK DRIVE KIT-B4

EFI-Fiery based controller options

FIERY IMPOSE
FIERY COMPOSE
FIERY IMPOSE AND COMPOSE
FIERY IMAGE VIEWER

System accessories

WEB ACCESS SOFTWARE-K1
SERIAL INTERFACE KIT-K2

FAX accessories

SUPER G3 FAX BOARD-AS1
SUPER G3 2ND LINE FAX BOARD-AS1
SUPER G3 3RD/4TH LINE FAX BOARD-AS1
REMOTE FAX KIT-A1
IP FAX EXPANSION KIT-B1

Other Options

Accessibility Accessories

ADF ACCESS HANDLE-A1
VOICE GUIDANCE KIT-G1
VOICE OPERATION KIT-D1

Staple Cartridge

STAPLE CARTRIDGE-X1
STAPLE CARTRIDGE-Y1

Footnotes

Supported media types

*1 Some types of tracing paper cannot be used.

Warm-up Time

*2 The time until key operations can be performed on
the touch panel display is 3 seconds or less.

Weight

*3 Including the toner bottle.

Direct Printing from memory media

*4 PDF print from websites is supported.

Power consumption

*5 0.9 watt sleep mode may not be possible in all
circumstances.



To arrange for a demonstration, simply contact any of our offices below.

Canon India Pvt. Ltd.

7th Floor, Tower B, Building # 5, DLF Epitome, DLF Phase III, Gurgaon, Haryana - 122002 | Ph : 91-124- 4160000

CANON OFFICES

MALAYSIA

Canon Marketing (Malaysia)
Sdn Bhd
Block D, Peremba Square
Saujana Resort Section U2,
40150 Shah Alam
Selangor Darul Ehsan, Malaysia
Tel : 60-3-7844 6200 /
7845 0055
Fax : 60-3-7844 6196 / 6198
www.canon.com.my

THAILAND

Canon Marketing (Thailand)
Co. Ltd
No.98 Sathorn Square
Office Tower, 22nd - 24th floor,
North Sathorn Road,
Silom, Bangrak,
Bangkok 10500
Tel : 66-2-344 9999
Fax : 66-2-344 9960
www.canon.co.th

VIETNAM

Canon Marketing (Vietnam)
Co. Ltd
Level 10, President Place,
93 Nguyen Du, Dist 1,
Ho Chi Minh City, Vietnam
Tel : 84-8-3820 0466
Fax : 84-8-3820 0477
www.canon.com.vn

INDIA

Canon India Private Limited
7th Floor, Tower B, Building #5,
DLF Epitome, DLF Phase III,
Gurgaon 122002,
Haryana, India
Tel : 91-124-416 0000
Fax : 91-124-416 0011
www.canon.co.in

HONG KONG

Canon Hongkong Co. Ltd
19F, The Metropolis Tower
10 Metropolis Drive
Hung Hom, Hong Kong
Tel : 852-3191-2388
Fax : 852-2369-3800
www.canon.com.hk

TAIWAN

Canon Marketing (Taiwan)
Co. Ltd
19F, No. 100,
Sec.2 Roosevelt Road,
Taipei, Taiwan, R.O.C.
Tel : +886 2-8632-8888
Fax : +886-2-6632-6700
www.canon.com.tw

PHILIPPINES

Canon Marketing
(Philippines), Inc.
7F Commerce and Industry
Plaza, 1030 Campus Avenue
corner Park Avenue, McKinley
Hill, Fort Bonifacio, Taguig City,
Metro Manila, Philippines 1634
Tel : 632-884-9000
Fax : 632-556-1456
www.canon.com.ph

CANON BUSINESS PARTNERS

AFGHANISTAN

Megaplus Afghanistan Limited
House No. 233, Street No. 4,
Charagh Ali,
Qilla-e-Fatehullah,
Kabul, Afghanistan
Tel : 93-700 228 832 /
93-700 979 5
Fax : 93-202 201 259
Email: info@megaplus.com.af

BANGLADESH

Flora Limited
Adamjee Court Annex-2
(4th Floor)
119-120 Motijheel
Commercial Area
Dhaka 1000 Bangladesh
Tel : 880-2-716-2742-46 / 225
Fax : 880-2-955-0030
www.floralimited.com

BRUNEI

Interhouse Company
No. 5-7 Bunut Jaya Complex
Spg 574 Jalan Tutong BF1320
P.O. Box 423, Seri Complex
Bandar Seri Begawan
BA 1779 Brunei Darussalam
Tel : 673-2-653-001
Fax : 673-2-653-003

CAMBODIA

Royal Cambodia Co., Ltd
#437 Preah Monivong Blvd
Phnom Penh
Kingdom of Cambodia
Tel : 855-23-428955
Fax : 855-23-722961

INDONESIA

PT Samalitro
Jalan Ir. H Juanda No.8
Jakarta 10120, Indonesia
Tel : 62-21-345 8989
Fax : 62-21-345 6699
www.samalitro.co.id

MALDIVES

Simdi Company Pvt Ltd.
G.Manaam Building,
2/1 Neeloofaru Magu,
Male' 20-129, Maldives
Tel : 960-333 4421
Fax : 960-333 4424

MYANMAR

Myanmar Golden Rock
International Co., Ltd
No. 79-D, Bo Chein Street,
Payay Road, 6 1/2 Mile,
Hlaing Township,
Yangon, Myanmar
Tel : 95-1-654810 to 19
(10 Lines),
95-1-654844 to 48
(5 Lines)
Fax : 95-1-654820
Email: sales@mng.com.mm

NEPAL

International Electronics
Concern (P) Ltd
Kha 14, 1st Floor
Haratibhawan Putalisadak
Ramshah Path,
Kathmandu, Nepal
P.O. Box 12588
Tel : 977-1-442 1991
Fax : 977-1-442 1909

PAKISTAN

Shirazi Trading Company
(Pvt.) Ltd
8th Floor, Adamjee House
I.I. Chundrigar Road
Karachi 74000 Pakistan
Tel : 92-21-3241 (7659),
(7737) or (7746)
Fax : 92-21-3241 7747),
(3242 0417) or
(3242 0418)
www.shirazitrading.com.pk

SRI LANKA

Metropolitan Office
(Pvt) Ltd
12, Magazine Road
Colombo 08
Sri Lanka
Tel : 94-11-470 0200
Fax : 94-11-470 0267
www.metropolitan.lk

This brochure and the specifications of the product have been developed prior to the date of product launch. These specifications are subject to change without notice. Therefore no representations or warranties, either express or implied, are made of the fitness of this product for a particular purpose. In no circumstances shall the information in this brochure be considered part of our terms and conditions of sale. You are advised to check the prevailing specification immediately prior to purchase.

All company and/or product names are trademarks and/or registered trademarks of their respective manufacturers in their markets and/or countries. Canon, imageRUNNER, imageRUNNER ADVANCE, imageCHIP, RAPID Fusing System, MEAP, eMaintenance, iW, Business can be simple and get Smart get genuine are trademarks of Canon Inc. and/or its affiliates. "MEAP" is a trademark of CANON Inc., referring to an "application platform" for Canon multifunction and single function printers. Other names may be the trademarks of their respective owners.

uniFLOW, eCopy and Therefore are independent party software distributed by Canon Singapore Pte Ltd.

0200W170 @ 2016 Canon Singapore Pte. Ltd.
All rights reserved.